

# Leicester Museum & Art Gallery

## Redevelopment Project Phase 1 A



# Leicester Museum & Art Gallery

---

- One of the first regional museums in the UK (1849) & Leicester's flagship
- Award winning and family friendly, but some areas are
  - need investment (wild space gallery / old Egypt gallery)
  - underused (back of house offices / library)
- Current café location limits income – can not open at different times to the museum



# Leicester Museum & Art Gallery

Leicester City Council

Ground Floor Proposal  
Phase 1A

20.06 - 00 - 03

# Leicester Museum & Art Gallery

New Walk's world of discovery

## Levels Key



Key Consideration Points: **No**

Floor Level raised in new Cafe to Gallery 1 +0mm

1 – Conservatory/Café Space on Forecourt

2 – New Entrance/Exit on to New Walk

3 – New Lift to connect Lord Mayor's Suite

4 – Stairs altered to accommodate new floor level

5 – Stairs upgraded to meet H&S standards

6 – Ramp into Gallery 5

7 – New entrance into new Leicester Stories Gallery (Community Gallery Project)

Hold open to existing doors: ●

Hold open to new doors: ●

Existing roller shutters: ●

New auto doors: ●

New roller shutter: ●

Doors without tags are to remain as existing. Make allowance for replacing / upgrading some doors existing doors in line with fire requirements.

Extent of Works:

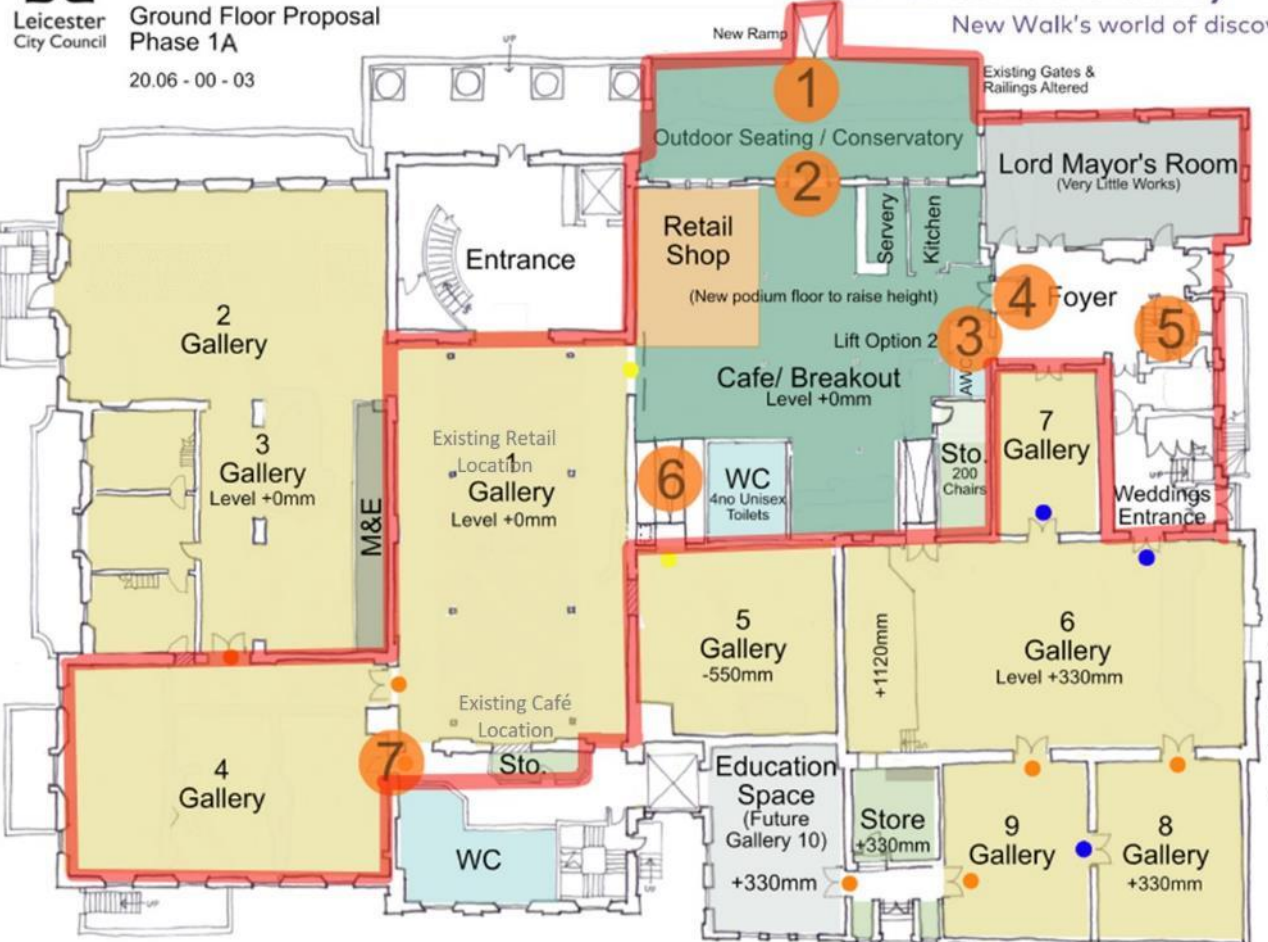



# Leicester Museum & Art Gallery

First Floor  
Phase 1A

20.06 - 01 - 003

# Leicester Museum & Art Gallery

New Walk's world of discovery

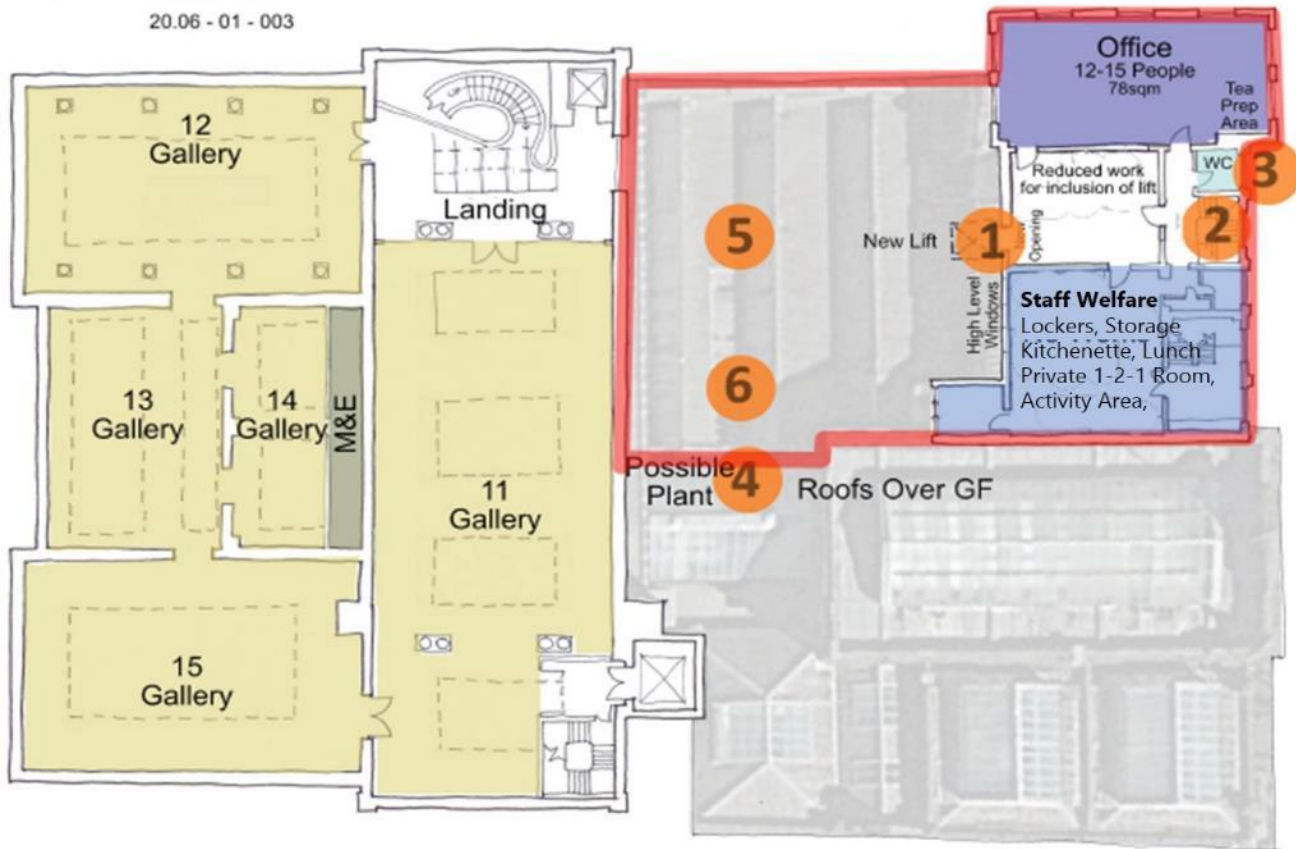

## Key Consideration Points: No

- 1 – New lift
- 2 – Stairs upgraded to meet H&S standards
- 3 – Repair/Upgrade toilet facilities
- 4 – Roof based M&E plant
- 5 – Rooflight alterations
- 6 – Maintenance access improvements

Extent of Works:

# Development Areas



- 1 – New Café Entrance & Conservatory
- 2 – Wild Space – New Café Location
- 3 – Wild Space – New Café Location
- 4 – Existing Café in Gallery 1
- 5 – New Café Entrance & Conservatory (between Portico & Lord Mayor's Building)

# Development Areas



Location of new Leicester Stories Gallery

- 1 – External view of Library & Offices  
(Museum Square / Princess Road West)
- 2 – Library Offices facing Museum Square
- 3 – Library Mezzanine Storage
- 4 – Library from the Mezzanine  
(facing existing Café / Gallery 1)

# Development Areas



- 1 – New Staff Welfare Facilities, first floor Lord Mayor’s Building (previously Conservation Studio) facing Princess Road West
- 2 – New Staff Welfare Facilities, first floor Lord Mayor’s Building (previously Conservation Studio) facing New Walk
- 3 – New Staff Office, first floor Lord Mayor’s Building (ex Exhibition & Design Studio) Facing Waterloo Way
- 4 – New Staff Office, first floor Lord Mayor’s Building (ex Exhibition & Design Studio) Facing New Walk

# Ambition

---

- Position LMAG as regional flagship, with a much improved café & retail offer
- Revamp galleries to showcase our natural world / art collections
- Bring Story of Leicester up to date / reinterpret social history via Leicester Stories Galleries focusing on recent history / Leicester communities
- Key audiences: families, schools, young people, Leicester residents, tourists, community groups
- **Raise attendance to 300k plus per annum**